



## **UAA Engineering and Industry**

The RFP for the construction of the new School of Engineering Building required in the RFP, Neeser Construction issued to Neeser in October 2011) a new 4 story, 75,000+ gross sq ft and the existing 3 story, 40,000 gross sq ft.

Meetings began in early January 2012. Planning and Construction and Construction costs between the design and the early site work/footings and procurement package.

The 28<sup>th</sup> Alaska State Legislature passed the 2013. The original capital budget to complete the project. The FY 2013 budget the governor included \$15 million.

With the available funding and joint efforts to the construction of the building to be completed without any funding if funding is vetoed, UAA will purchase utilities, structure steel and an electrical package if funding is received.

With efforts focused on the construction development of three (3) Guarantees of Performance include site work, underground utilities, telecommunications, and structural steel/mechanical/electrical/plumbing (MEP). The final GMP, package #3, will include metal studs/structural steel, interior finishes, etc. for a complete building.

As UAA negotiates the GMP's right to re-scope/reconcile the summation of GMP costs for all (partial or full) for the construction package for site work and the building.

April 26, 2013. Costs were reconciled below the target cost. Contract documents are being prepared with a notice to proceed expected to be issued in early May 2013.

Construction coordination meetings with the contractor, consultants, and UAA groups are in progress. UAA property near Lake Otis and Providence Drive has been identified for use for contractor employee parking, material and equipment staging for the new building construction. The property is screened by vegetation on the north and west sides for concealment; the property is in close proximity to the project construction site.

The public hearing process has been coordinated with the University facilities staff, design team, MOA and local com.15 §e

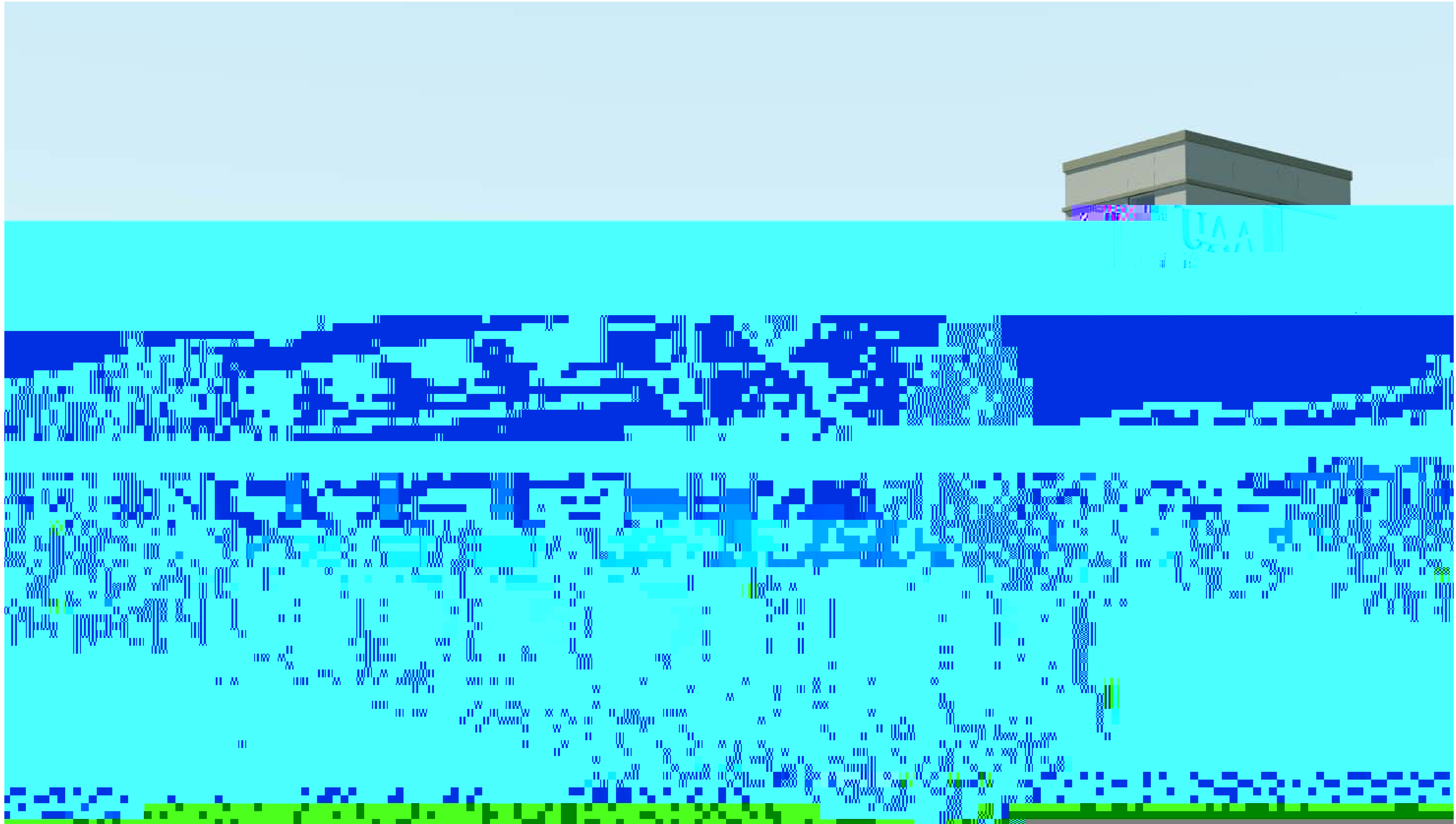

View from UAA Drive looking South

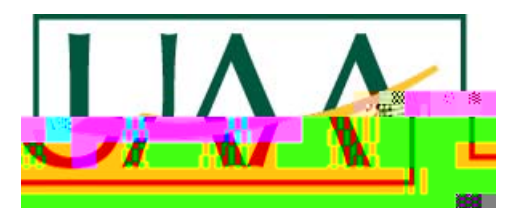

# School of Engineering Proposed Parking Structure



